

## Specifications

### Power:

Line voltages: 115 or 230VAC  
 Frequency: 50/60 Hz  
 Power consumption: 25W maximum

### Excitation Voltage:

5VDC  
 Load current: 115 mA maximum (8 x 350Ω load cells)

### Analog Signal Input Range:

0.5 mV/V - 3.5 mV/V

### Analog Signal Sensitivity:

0.3 mV/V/graduations minimum

### A/D Sample Rate:

7.5 to 60 Hz software selectable

### Resolution:

Internal: Eight million counts  
 Display: Selectable up to 100,000d

### System Linearity / PI Rating:

Within 0.01% of FS

### Digital I/O:

Two inputs, TTL or switch closure, active low  
 Two outputs, 250mA max sink

### Circuit Protection:

ESD, EMI, RFI protected

### Communication Ports:

Printer port: RS-232 full duplex 20mA simplex  
 EDP Port: RS-232 full duplex  
 Baud rates: 300 to 38,400 seven or eight data bits;  
 even, odd or no parity

### Status Annunciators:

Tare, entered tare, standstill, net, gross, center of zero,  
 minus sign, lb, kg

### Display:

2 in (50 mm) LED Display,  
 Decimal point available at each digit

### Keys/Buttons:

Five-button rubber-booted watertight switches

### Temperature Range

Operating: 14°F to 104°F (-10°C to 40°C)

### Rating/Material:

NEMA Type 4X FRP

### Weight:

Approximately 18 lb (8.2 kg)

### Warranty:

Two-year limited warranty

### Approvals:

NTEP CC 04-076, Class III/IIIL 10,000d  
 Measurement Canada AM-5554, Class III/IIHD  
 10,000d

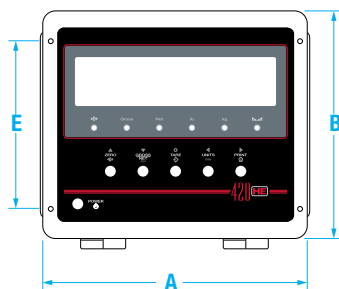
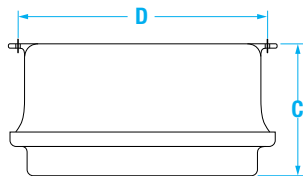

## Standard Features

- NEMA Type 4X fiberglass-reinforced polyester (FRP) enclosure
- LED display, 2 in
- Universal mounting tabs (replaceable)
- Up to 60 updates/second
- Selectable display update rate
- Five-button operation, environmentally protected mechanical switches
- Two communication ports, full duplex RS-232
- RATTLETRAP® vibration control
- Configurable with Revolution® software

## Approvals



Measurement  
 Canada  
 Approved

## Part Number/Price

| Part #  | Description            | Est. Weight | Price   |
|---------|------------------------|-------------|---------|
| 87959 † | SURVIVOR 420HE 115 VAC | 18 lb       | Consult |
| 87960 † | SURVIVOR 420HE 230 VAC | 18 lb       | Consult |

## Options/Accessories

| Part # | Description                         | Price   |
|--------|-------------------------------------|---------|
| 30911  | Additional mounting tabs (set of 4) | Consult |
| 92777  | Filter, PreVent™ vent kit           | Consult |
| 87972  | Additional operating manual         | Consult |

### Primary Component Parts

|       |                                  |         |
|-------|----------------------------------|---------|
| 87958 | Board assembly, CPU              | Consult |
| 72996 | AC power supply                  | Consult |
| 87808 | Board display, 2 in LED          | Consult |
| 87971 | Switch assembly, six push button | Consult |
| 87968 | Front panel overlay              | Consult |



## Dimensions

|   |                   |   |                   |
|---|-------------------|---|-------------------|
| A | 12.50 in (318 mm) | D | 14.94 in (379 mm) |
| B | 10.50 in (267 mm) | E | 10.00 in (254 mm) |
| C | 8.28 in (210 mm)  |   |                   |